

NRT - Tokyo Narita International Airport Tokyo Customs

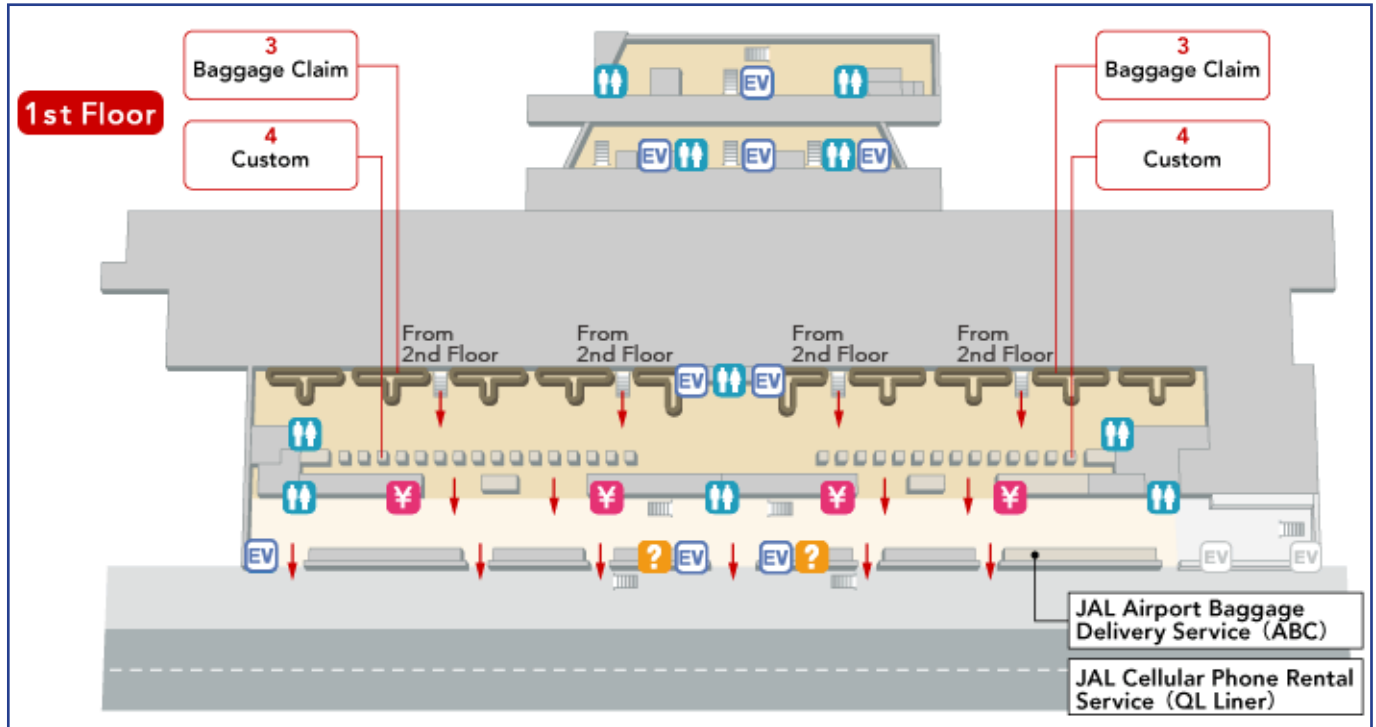

Carnet & Customs Instructions

Carnet users must have their carnets validated both when arriving and departing.

- 1) Bring Carnet and items to Public Office located on the 4th floor of Terminal 1 on the N&S wing.
- 2) Press button for intercom. Also located on the 3rd floor of Terminal 2.

Hours of operation: 8:30 am-5 pm

Airport Information

Website

www.narita-airport.jp/en/index.html

Customs Service +81(0)476-34-2128

Parking Customer Service +81(0)476-32-0618

Customer Service +81(0)476-32-0618

Information is accurate as of May 1st, 2016 but can change at any time.

Please allow sufficient time to locate customs and get your carnet validated should the location of customs change due to conditions beyond our control.

Language Aid

Present this language aid to be directed to the nearest Customs area in this Airport.

Please direct me to the nearest Customs area. (English)

この空港内で一番近いを税関を教えてください。 (Japanese)

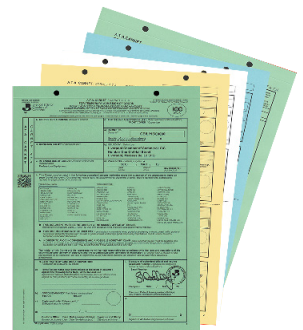

BCL International HelpLine..... 0808 189 3400 E-Mail carnets@boomerangcarnets.co.uk
 U.S. Corporate Headquarters 847-852-3100 Website www.boomerangcarnets.co.uk